

# Installation Instruction

Smart Rotary Dimmer Switch  
Single Pole

**ELEGRP**

## PRODUCT INTRODUCTION

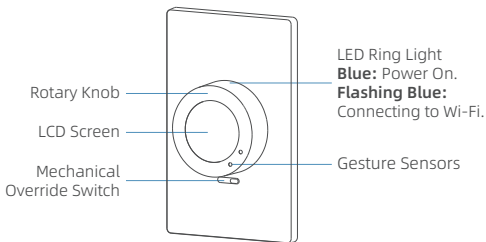

Smart Rotary Dimmer Switch

## KNOB OPERATION

	Press	Rotate	Press & Hold
Switch	On/Off	Control brightness	/
Setting	Confirm options	Shift options	Enter or exit the setting menu

## TOOLS NEEDED



Flat-Head  
Screwdriver



Philips  
Screwdriver

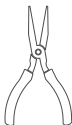

Wire Strippers  
(recommended)



Test Pencil  
(recommended)

# WHAT'S IN THE BOX

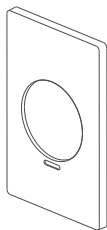

Dedicated Face Plate

Knob Screws



Rotary Knob

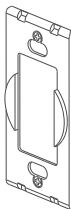

Dedicated  
Fixing Plate



Dimmer  
Switch Base



**Do not force to pull out the knob before removing the knob screws, otherwise the device will be destroyed.**



2 x Crescent Plate Kits  
\* For compatible with the  
NEMA standard decorative  
wall plate.



2 x Wall Plate Screws  
2 x Mounting Screws  
( Pre-installed )



Wire Labels



Wire Connectors

## CHECK COMPATIBILITY

**Rating:** 120VAC, 60Hz

**Operating Temperature:** 0°C~40°C (32°F~104°F)

**Storage Temperature:** -20°C~70°C (-4°F~158°F)

**Wiring Type:** Single Pole

**LCD Resolution:** 240\*240 dpi

### Compatible Bulb Types and Max Load



Dimmable LED  
150W



Dimmable CFL  
150W



Incandescent  
450W

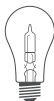

Halogen  
450W

Due to the larger size of the rotary knob, it is not feasible to install rotary dimmer switches side by side in a multi-gang wall plate.

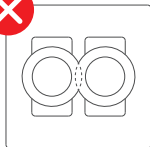
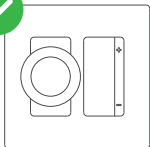

**The white neutral wire is required to connect.** The device will not function if the neutral wire is not connected.

## BEFORE WE START



**⚠ WARNINGS:** To avoid fire, shock, or death, [turn off power at circuit breaker or fuse](#) and test that the power is off before wiring!

**⚠ CAUTIONS:** To reduce the risk of overheating and possible damage to other equipment, [DO NOT](#) install to control a receptacle, a motor operated appliance, a fluorescent lighting fixture, or a transformer-supplied appliance.

**⚠ AVERTISSEMENTS:** Pour éviter le feu, les chocs ou la mort, [éteignez le disjoncteur ou le fusible](#) et vérifiez que l'alimentation est coupée avant le câblage!

**⚠ ATTENTIONS:** Pour réduire le risque de surchauffe et d'endommagement possible d'autres équipements, [NE PAS](#) installer pour contrôler une prise, un appareil actionné par moteur, un appareil d'éclairage fluorescent ou un appareil alimenté par un transformateur.



**Consult a qualified electrician** if you are unfamiliar with electrical codes and regulations, or are uncomfortable performing the installation.

## REMOVE WALL PLATE

Determine the type of wall plate your smart rotary dimmer switch is going to be installed with (different in opening shapes):

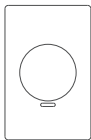

Dedicated Wall Plate (supplied)

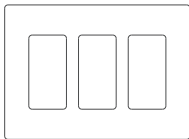
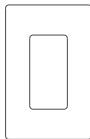

NEMA Standard Decorative Wall Plate

a) If your smart rotary dimmer switch is going to be installed with the **dedicated wall plate (special for this ELEGRP smart rotary dimmer switch)**:

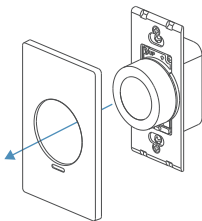

Push a flat-head screwdriver into the slot at the bottom of the dedicated face plate. Gently pry apart to remove the face plate.

b) If your smart rotary dimmer switch is going to be installed with a **NEMA standard decorative wall plate (the same opening size as wall plates from any brand)**:

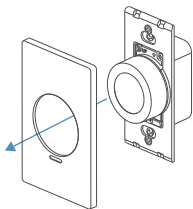

1. Push a flat-head screwdriver into the slot at the bottom of the dedicated faceplate. Gently pry apart to remove the face plate.

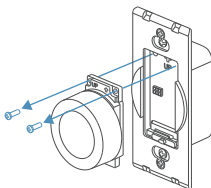

2. Use a Philips screwdriver to remove the screws from the rotary knob and then remove the rotary knob itself.

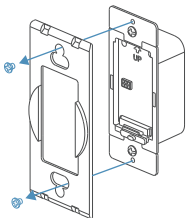

3. Use a Philips screwdriver to remove wall plate screws and dedicated fixing plate.

## REMOVE OLD SWITCH

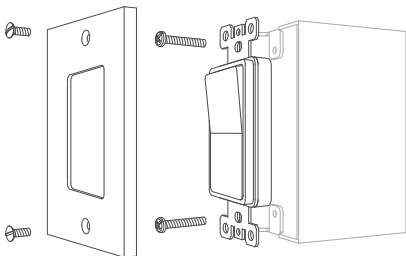

After power is turned off, remove wall plate and switch mounting screws. Carefully pull out the old switch from the wall box (do not remove wires).

### Turn Off Power



Before removing, turn off power at circuit breaker or fuse and use a test pencil to confirm whether power is off before wiring or servicing fixture!



# IDENTIFY & LABEL WIRES

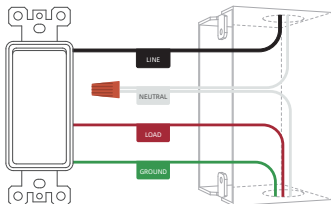

Wire Label	Line	Load	Neutral	Ground
Wire Color	Black	Red or Black	White	Green or Bare Copper

## STEP 1: Identify and Label Neutral & Ground

Neutral wires are usually white and Ground wires are usually green / bare copper.

## STEP 2: Identify and Label Line & Load

Turn on power and test the remaining wires with a test pencil. When the test pencil glows, then that wire is line wire, but when the pencil does not glow at all, then that is load wire. [Turn off the power](#) at the circuit breaker before labelling the wires.

## Be Safe



To prevent severe shock or electrocution, make sure your fingers **do not touch** the wall box, wires or the screw terminals when power is restored!

## STRIP WIRES



Disconnect wires from the switches, make sure that the ends of the wires from the wall box are straight (cut if necessary).

Remove 0.6" (15mm) of insulation from each wire in the wall box.

## CONNECT SWITCH

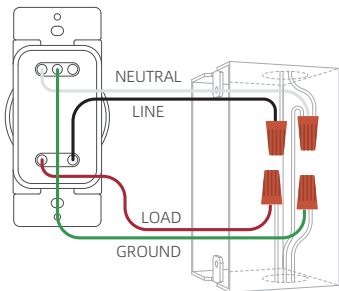

Use provided wire connectors to connect wires in the wall box to the wires of the smart switch. Match every wire as labeled.

## FINISH WIRING

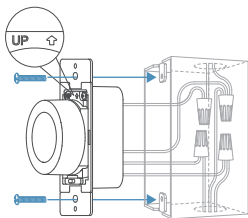

Form all wires carefully into wall box, and mount switch with mounting screws supplied.

(\*The rotary knob may have been removed. )



### Important

Do not mount the switch upside down.

## MOUNT WALL PLATE

a) If your smart rotary dimmer switch is going to be installed with the **dedicated wall plate (special for this ELEGRP smart rotary dimmer switch)**:

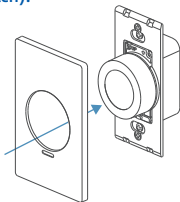

Push the dedicated face plate onto the dedicated fixing plate and snap it into place.

b) If your smart rotary dimmer switch is going to be installed with a **NEMA standard decorative wall plate (the same opening size as wall plates from any brand)**:

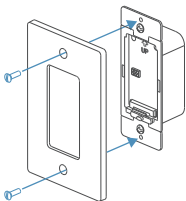

1. Use the wall plate screws to mount the NEMA standard decorative wall plate.

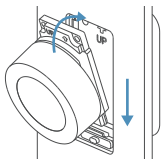

2. Insert the rotary knob into the bottom slot. Push the knob in.

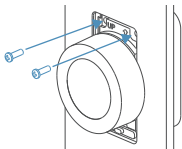

3. Screw the knob with the torque values within 9.0 in-lbf (1.0 N·m).

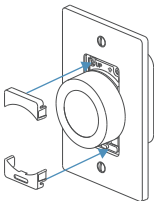

4. Push one crescent plate with a mechanical override switch hole into the bottom slot, and another into the top slot around the rotary knob. Snap them securely into place.

# TROUBLESHOOTING

## After installation, the switch does not turn on?

- If the LCD screen does not light up
  - Check if the circuit breaker or fuse is connected properly.
  - Try swapping your Line and Load wires.
- If the LCD screen lights up
  - Check that the bulb is properly installed and has not failed.

## Difficulty in connecting smart switch to a Wi-Fi network?

- Make sure the Wi-Fi network is a 2.4 GHz network.
- The Wi-Fi connection may not have good coverage. Try moving your Wi-Fi router closer to the smart switch.

## What should I do when the bulb is flickering?

This dimmer switch has been set by default to dim a broad range of dimmable LED, CFL, incandescent and halogen lights. However, the dimming range of dimmable CFLs and LEDs can vary from bulb to bulb.

- a) If the flickering only happens at low brightness range, please set the minimum brightness to a higher level where the bulbs light up without flickering.
  - On the Smart Rotary Dimmer Switch: Press and hold the rotary knob to enter the setting menu. Rotate the knob to select "Set Minimum Brightness" and press to confirm. Then you can adjust the minimum brightness by rotating the knob.
  - In the ELEGRP HOME App: Tap your smart rotary dimmer switch and then go to "Configure-Set Minimum Brightness".
- b) If the flickering happens during the whole dimming range, please make sure you are using dimmable bulbs or consider replacing your bulb(s) with a different model.



Refer to help center in the app for additional troubleshooting suggestions

# HAVING PROBLEMS? WE CAN HELP!

Email: [support@elegroup.com](mailto:support@elegroup.com)

Call us on: 866-267-3272 Mon-Fri 9:00-17:00 EST (US)

Feel free to contact us with any questions or concerns.  
Our customer service team will work hard to put a smile  
back on your face.

## About Us

Website: [www.elegroup.com](http://www.elegroup.com)

Search **ELEGRP** on social media